

Plastic Welding Equipment Extended Flanges

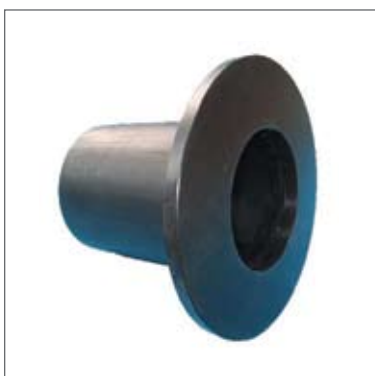
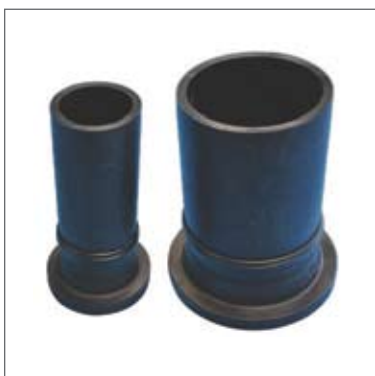

Stub Flanges Extended	Code	Price
20mm (1/2") stub flange with 250mm long extension	0501000	
25mm (3/4") stub flange with 250mm long extension	0502000	
32mm (1") stub flange with 250mm long extension	0503000	
50mm (1 1/2") stub flange with 250mm long extension	0505000	
63mm (2") stub flange with 250mm long extension	0506000	
90mm (3") stub flange with 250mm long extension	0508000	
110mm (4") stub flange with 250mm long extension	0509000	
160mm (6") stub flange with 250mm long extension	0512000	
200mm (8") stub flange with 250mm long extension	0514000	
225mm (8") stub flange with 250mm long extension	0515000	
280mm (10") stub flange with 300mm long extension**	0517000	
315mm (12") stub flange with 300mm long extension**	0518000	
Internal Chamfering (all flange sizes) upon request	7050000	

Full Face Flanges Extended - Undrilled	Code	Price
32mm (1") full face flange with 250mm long extension	0403000	
50mm (1 1/2") full face flange with 250mm long extension	0404000	
63mm (2") full face flange with 250mm long extension	0405000	
90mm (3") full face flange with 250mm long extension	0408000	
110mm (4") full face flange with 250mm long extension	0409000	
160mm (6") full face flange with 250mm long extension	0412000	
Full face flange drilling (all flange sizes) upon request	7050000	

These prices do not include G.S.T
Effective 01/01/09